

### Salice

- 270° opening angle with a type 2 mounting plate
- Side adjustment -3 mm to +3 mm
- Height adjustment  $\pm 2$  mm
- Depth adjustment +2.8 mm with a type 2 mounting plate
- Tested in accordance with ANSI/BHMA Grade 1 standards
- Maximum door thickness: 20 mm (3/16")
- Hinges are self-closing; magnetic catches are not required

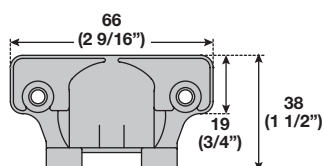

### Single Pivot Hinge

Material: Steel; Finish: nickel plated

Model	Mounting	Item No.
CMP3A99	screw	329.58.600
CMR3A99	dowel	329.58.610

Full overlay with recessed knuckle application



Partial overlay with external knuckle application



Application with inset door

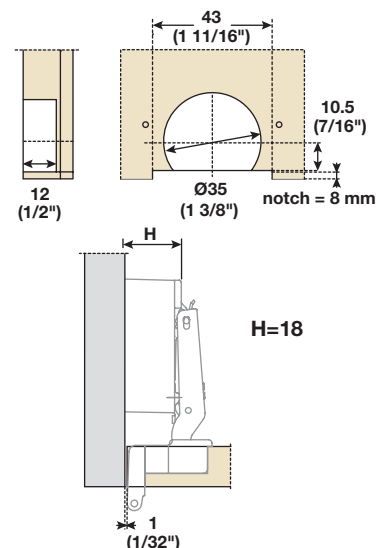
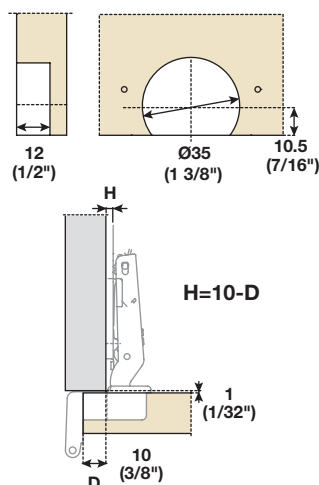
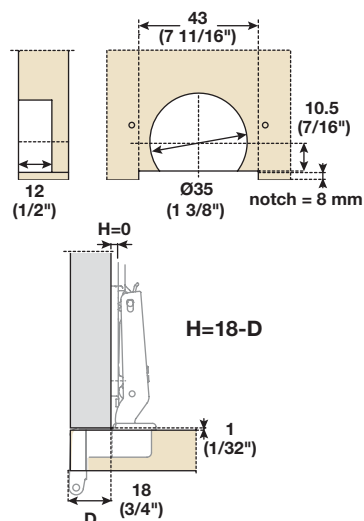

Formula to determine baseplate:

D=overlay

H=baseplate

Dimensional data not binding. We reserve the right to alter specifications without notice.

Dimensions in mm  
Inches are approximate