

### Grass TIOMOS

- Soft close or self close
- Screw or dowel mounted
- Door thickness up to 32 mm (1 1/4")
- Shallow cup drilling depth: 10 mm (3/8")
- Accommodates overlays up to 25.4 mm (1")

#### Note

Dimensions in drawings and tables are calculated using factory settings and for mounting plate height 2 mm (3/32").

#### Dowel mounted

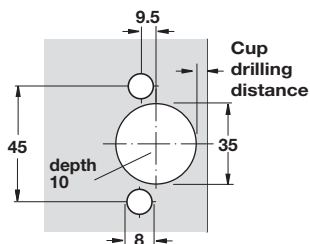

#### Screw mount

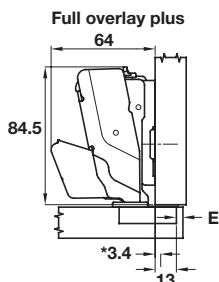
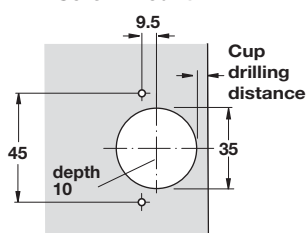

#### Full overlay

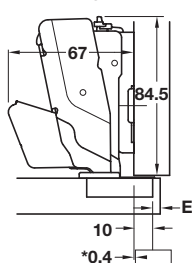

#### Inset

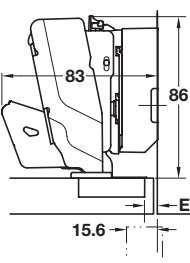

\*Zero protrusion when door is at 90°

#### Half overlay

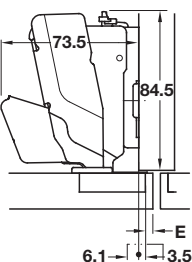

soft&silent)))

Opening angle: **160°**

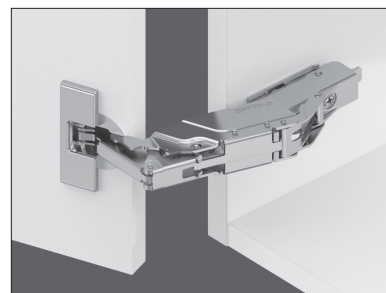

### Full Overlay Plus

- For large door overlay up to 24 mm
- For door thickness up to 32 mm (for door thicknesses over 29 mm, a trial fitting is recommended)

Material: Steel; Finish: nickel-plated

Version	Hinge Arm	Screw	Dowel
soft close		348.32.800	348.32.810
self close		348.32.600	348.32.610

Door Overlay	15	16	17	18	19	20	21	22	23	24	25
0 baseplate				3	4	5	6	7	8	9	10
2 baseplate		3	4	5	6	7	8	9	10		

E - cup drilling distance

### Full Overlay/Inset Mounting

Material: Steel; Finish: nickel-plated

Version	Hinge Arm	Screw	Dowel
soft close		348.32.801	348.32.811
self close		348.32.601	348.32.611

Door Overlay	12	13	14	15	16	17	18	19	20	21	22
0 baseplate				3	4	5	6	7	8	9	10
2 baseplate		3	4	5	6	7	8	9	10		

E - cup drilling distance

#### Note

For inset mounting use 19 mm mounting plate. Set mounting plate back by door thickness + 1.5 mm.

### Half Overlay

Material: Steel; Finish: nickel-plated

Version	Hinge Arm	Screw	Dowel
soft close		348.32.802	348.32.812
self close		348.32.602	348.32.612

Door Overlay	5.5	6.5	7.5	8.5	9.5	10.5	11.5	12.5	13.5	14.5	15.5
0 baseplate				3	4	5	6	7	8	9	10
2 baseplate		3	4	5	6	7	8	9	10		

E - cup drilling distance

### Opening Angle Restraint

- For use with Tiomos 160° hinges
- Prevents the door from butting against front panels or walls with corner mounting

Material: Plastic; Color: black

Opening Angle	Item No.
120°	348.40.011

Dimensions in mm  
Inches are approximate