

Pegaso 20

- Maximum door weight: 20 kg (44 lbs.)
- Minimum inside clearance width of cabinet: 398 or 475 mm (15 11/16" or 18 11/16")
- Maximum inside clearance height of cabinet: 2576 mm (8' 5 7/16")
- Adjustment options: ± 4 mm (1/8") vertical, ± 2 mm (1/16") horizontal ± 2 mm (1/16") on the incline
- Door wing swings to the front and side during opening
- Use in straight cabinets or in corner solutions

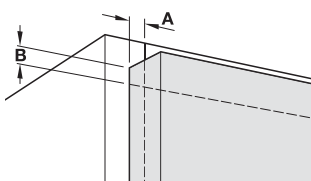

A = Door side overlay
B = Door overlay top and bottom

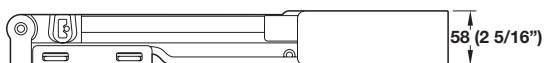
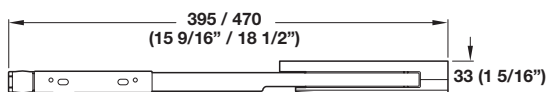
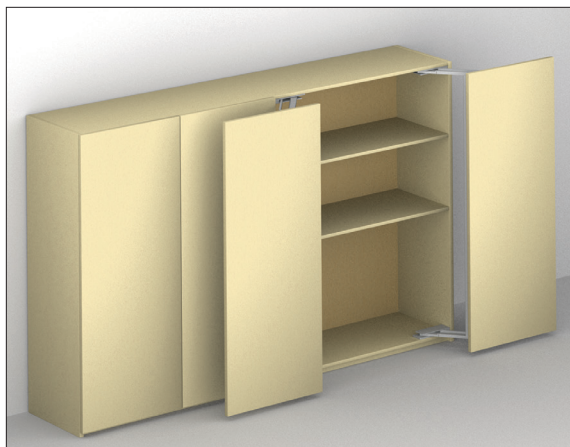
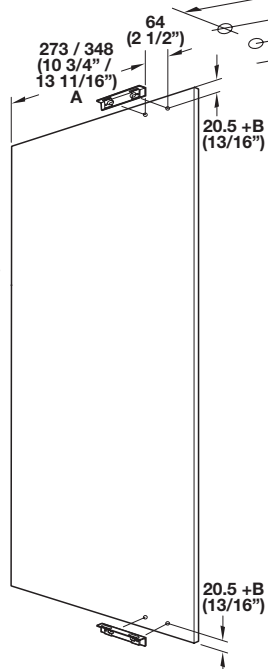
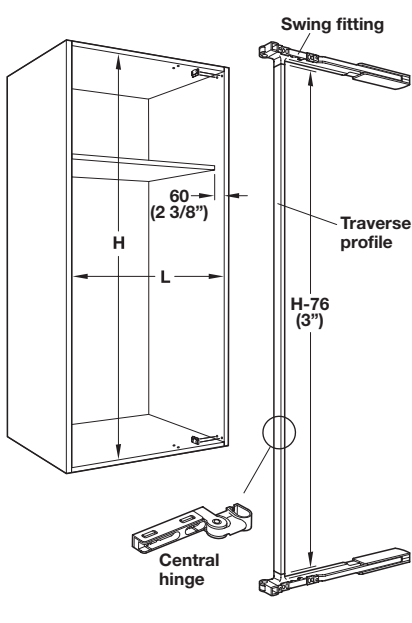

soft&silent)))

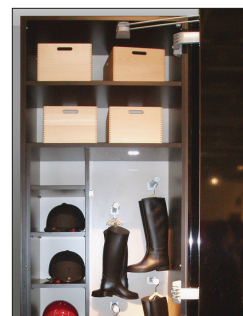

Complete Set

Material: Zinc die-cast, powder-coated; Color: silver

Model	Minimum cabinet width	Opening path	Item No.
450	398 (15 5/8")	450 (17 3/4")	407.32.906
600	475 (18 3/4")	600 (23 5/8")	407.32.907

Supplied With

- 1 pair swing fittings
- 2 door fastening brackets
- Installation instructions

Note

Order the traverse profile and center hinge separately.

Traverse Profile

Material: Aluminum, plastic-coated

Color	Item No.
silver	407.32.910

Central Hinge

Material: Zinc die-cast, powder-coated

Color	Item No.
silver	407.32.930

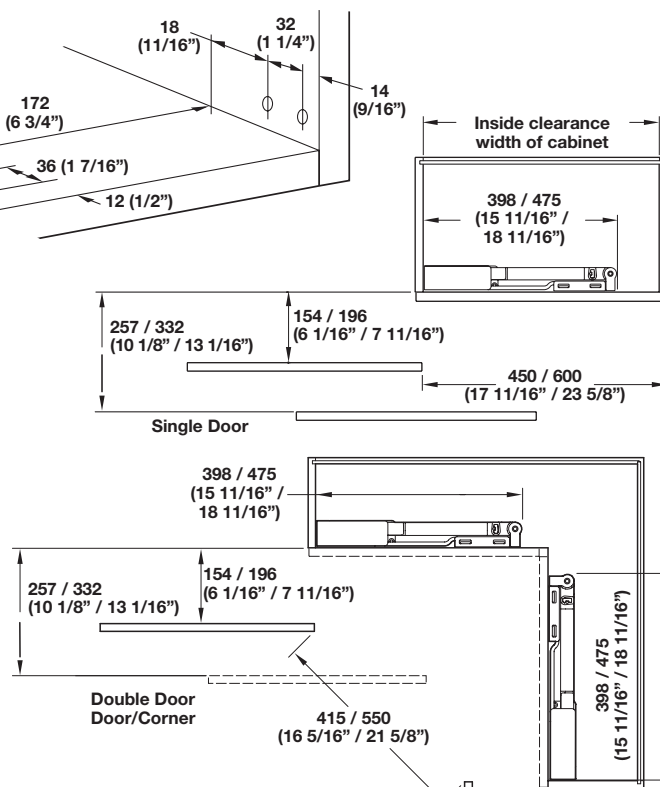

Dimensions in mm
Inches are approximate