

- Offers a wider range of adjustment with fewer items
- Allows for greater flexibility at installation
- Components ordered separately

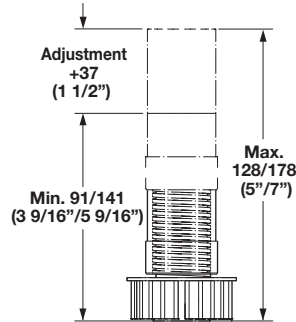
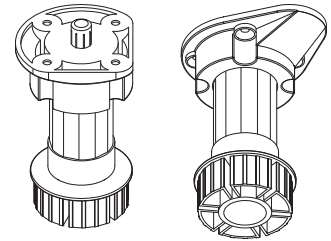

**Adjustment Foot**

- Shaft Ø30 mm (1 3/16")
- Load rating: 250 lbs.

Material: Plastic; Color: black

Base Height	Item No.
91 (3 9/16")	637.54.311
141 (5 9/16")	637.54.313

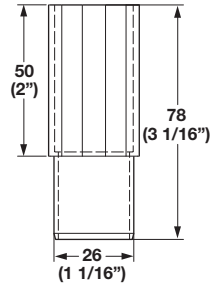

**Extension Tube**

- Offers 50 mm (2") of additional height
- Press-fit into adjustable foot tube

Material: Plastic

Color	Item No.
black	637.54.320

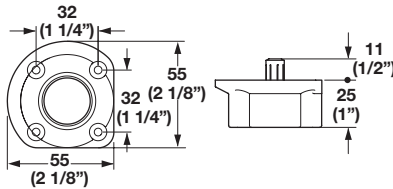

**Mounting Socket**

- Dowel-mounted

Material: Plastic

Color	Item No.
black	637.54.330

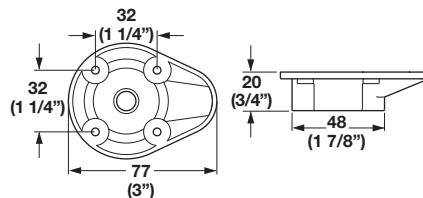

**Mounting Socket**

- Screw-mounted

Material: Plastic

Color	Item No.
black	637.54.335

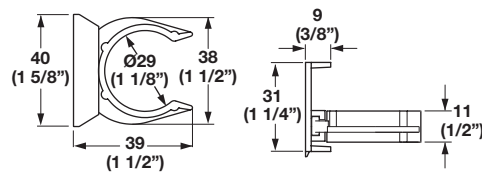

**Plinth Clip**

- Screw-mounted to base panel

Material: Plastic

Color	Item No.
black	637.54.340

Dimensional data not binding. We reserve the right to alter specifications without notice.

6