

Bed Box Casters

- With screw-on mounting plate
 - Bed box casters feature a wide tread for easy movement on carpet
 - The side mounting facility and low height make it suitable for installation in limited clearance areas
- Load capacity: 40 kg (88 lbs.) per caster

Material: Housing: Steel; Wheel: Hard Plastic

Finish/Color	Item No.
zinc-plated, white wheel	660.98.904
black zinc, black wheel	660.98.304

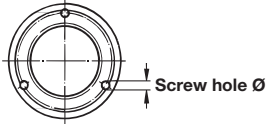
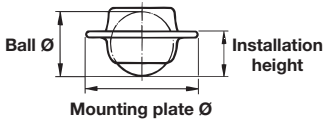

Ball Casters

- With screw-on mounting plate and reinforced base
- The ball casters can be moved in any direction
- When mounted upside down they can be used as a conveyor system for transporting heavy loads

Material: Housing: Steel; Finish: yellow chromate; Ball: Steel; Finish: chrome-plated

	Item No.		
	661.02.210	661.02.230	661.02.250
Ball Ø	13 (1/2")	20 (13/16")	25 (1")
Approx. load capacity per caster	6 kg (13 lbs.)	12 kg (26 lbs.)	17 kg (37 lbs.)
Installation height	10 (3/8")	15 (9/16")	20 (13/16")
Ø insert part	16 (5/8")	23.5 (15/16")	33 (1 5/16")
Insert depth	5.5 (3/16")	8.5 (5/16")	12 (1/2")
Mounting plate Ø	25 (1")	35 (1 3/8")	45 (1 3/4")
Screw hole Ø	2 (1/16")	3 (1/8")	3 (1/8")



Coal Box Casters

- With screw-on mounting plate, free-running
- Suitable for all low level storage boxes
- When mounted upside down they can be used as a conveyor system for transporting heavy loads

Material: Housing: Steel; Finish: zinc-plated; Wheel: Plastic; Color: black

	Item No.			
	661.23.322	661.23.304	661.23.313	661.25.906
Wheel Ø	15 (9/16")	25 (1")	30 (1 3/16")	45 (1 3/4")
Load capacity per caster	15 kg (33 lbs.)	20 kg (44 lbs.)	25 kg (55 lbs.)	50 kg (110 lbs.)
Installation height	17.5 (11/16")	28 (1 1/8")	32 (1 1/4")	48.5 (1 15/16")
Mounting plate L x W	30 x 17 (1 3/16" x 11/16")	40 x 17 (1 9/16" x 11/16")	45 x 20 (1 3/4" x 13/16")	67 x 27 (2 5/8" x 1 1/16")
Hole distance	20 (13/16")	30 (1 3/16")	35 (1 3/8")	54 (2 1/8")
Wheel width	13 (1/2")	13 (1/2")	15 (9/16")	19 (3/4")
Screw hole Ø	4 (3/16")	4.3 (3/16")	5 (3/16")	5.2 (3/16")

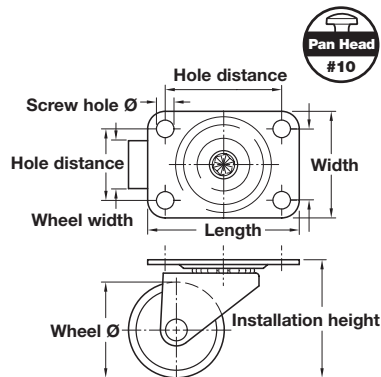
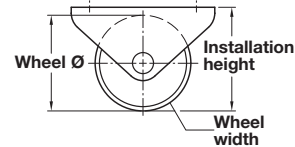
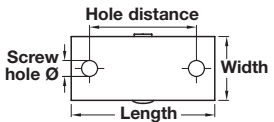

Swivel Casters

- With screw-on mounting plate
- Plastic, abrasion-proof wheels run in friction bearings
- Hard wheel surface, suitable for soft floor coverings
- Double ball-bearing in the ring mount, free-running

Material: Housing: Steel; Finish: zinc-plated; Wheel: Plastic; Color: black

	Item No.	
	662.03.861	662.03.870
Wheel Ø	30 (1 3/16")	40 (1 9/16")
Load capacity per caster	30 kg (65 lbs.)	35 kg (77 lbs.)
Installation height	48 (1 7/8")	63 (2 1/2")
Mounting plate L x W	38 x 38 (1 1/2" x 1 1/2")	42 x 42 (1 5/8" x 1 5/8")
Hole distance	30 x 30	30 x 30
Wheel width	15 (9/16")	20 (13/16")
Screw hole Ø	4.3 (3/16")	5 (3/16")

Dimensional data not binding. We reserve the right to alter specifications without notice.

Pan head screws

Pages 11.139-11.140

Dimensions in mm
Inches are approximate