

- Shelf width must be 6 – 7 mm less than the inside cabinet width

Tightening in drilled hole Ø5 mm

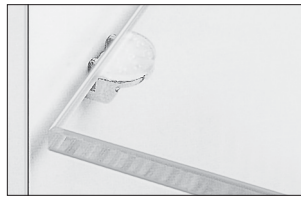

After the shelf support has been tightened in the side panel the glass shelf is put into place...

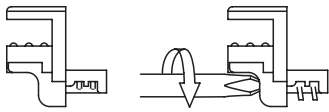
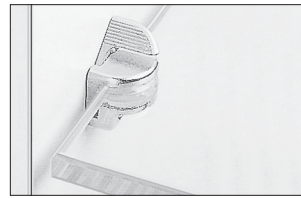

...then the tightening element is inserted.

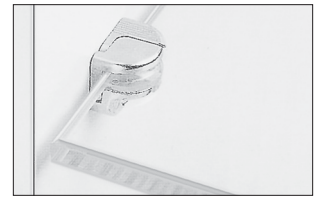

Pressing down on the tightening element fixes the glass shelf in position. The shelf support prevents it from tipping as well as being unintentionally lifted and removed.

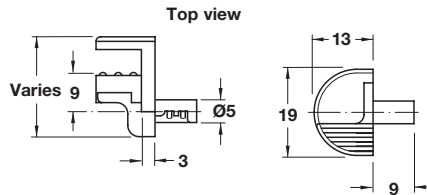

Ø5 mm

- For insertion and tightening in a drilled hole
- Variable for different glass thickness: 6/8/10 mm

Material: Zinc alloy; Glass rest: Plastic, transparent

Finish	Item No.
nickel-plated	282.13.711

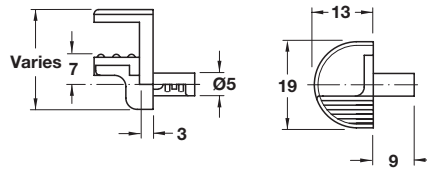

- Variable for different glass thickness: 8/10/12 mm

Finish	Item No.
nickel-plated	282.13.712

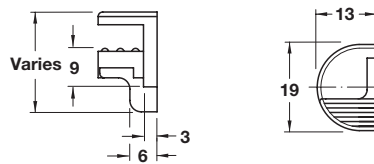

Ø5 mm

- Screw-mounts into a 5 mm drilled hole
- Variable for different glass thickness: 6/8/10 mm

Material: Zinc alloy; Glass rest: Plastic, transparent

Finish	Item No.
nickel-plated	282.13.701

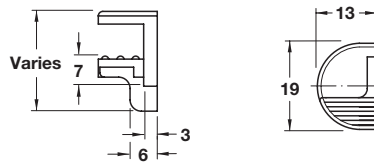

- Variable for different glass thickness: 8/10/12 mm

Finish	Item No.
nickel-plated	282.13.702

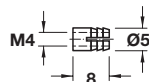

Spreading Dowel

- With M4 internal thread

Material: Brass, bright

Item No.
051.45.004

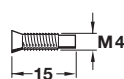

Ø5 mm

- With M4 internal thread
- Suitable for spreading dowel above

Material: Steel

Finish	Item No.
nickel-plated	282.13.791

Dimensional data not binding. We reserve the right to alter specifications without notice.

Dimensions in mm
Inches are approximate