

Ø5 mm

Material: Zinc die-cast

Finish	Item No.
nickel-plated	282.24.711

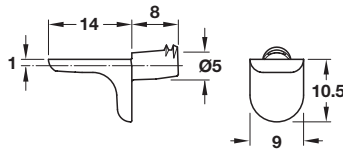
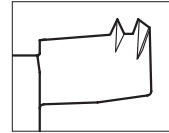

Ø5 mm

- With 2 wedged ribs
- Load bearing capacity: 275 lbs.

Material: Zinc die-cast

Finish/Color	Item No.
nickel-plated	282.24.710
black	282.24.310

Note

Ribs anchor themselves in the system holes due to pressure from the shelf, which is an important feature for areas prone to earthquakes

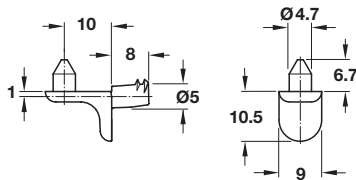
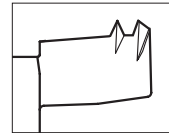

Ø5 mm

- With 2 wedged ribs and shelf-fixing plug

Material: Zinc die-cast

Finish	Item No.
nickel-plated	282.24.720

Note

Ribs anchor themselves in the system holes due to pressure from the shelf, which is an important feature for areas prone to earthquakes

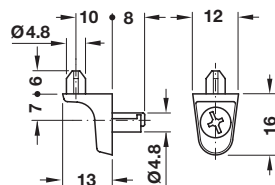
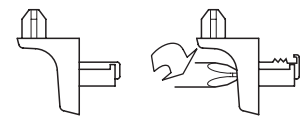

Ø5 mm

- For insertion and tightening into a drilled hole
- Load bearing capacity: 165 lbs.

Material: Zinc alloy

Finish	Item No.
nickel-plated	282.26.715

Dimensional data not binding. We reserve the right to alter specifications without notice.