

Combination Locks

National Lock – DualAxess

The DualAxess combination lock replaces standard cam locks to allow keyless access using your own personal code. The lock retrofits into an existing 3/4" hole, and can be mounted vertically or horizontally on flush, overlay, or lipped/overlay applications. Attach the provided cam for 90° latching in any direction.

- Open using either a combination or override key
- Once unlocked, rotate the housing 90° clockwise to unlatch
- Combination can only be changed with the override key and current combination
- 10,000 possible combinations are available using any four-digit number

To unlock using combination:

Turn wheels until correct combination appears in the combination windows. Press button, and rotate housing to unlatch. Scramble wheels to lock.

To unlock using key:

Insert key into lock plug and rotate 90° clockwise. Rotate housing to unlatch. Important: Rotate key 90° counterclockwise to lock.

Changing the combination:

1. Set to correct combination
2. Insert key and turn 90° clockwise to unlock
3. Remove the key
4. Insert the end of a large paper clip and push all the way in against the spring
5. While pressing and holding the paper clip against the spring tension, spin the dials to the new code in the combination windows
6. Remove paper clip and record the new combination
7. Insert key and turn 90° counterclockwise
8. Remove the key and press button to verify the new combination

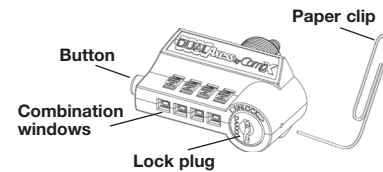
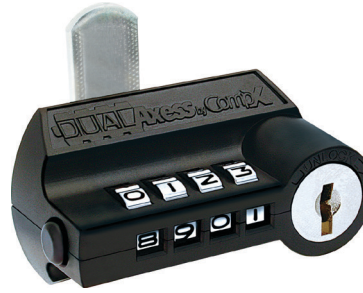

Keyless Cam Lock

- For right hand, left hand, or drawer applications
- Cam travels 90° and can be re-oriented

Material: Lock housing: die-cast
Cylinder: Brass

Cylinder length	National No.	Item No.
22 (7/8")	D8030-DA124	235.62.300
35 (1 3/8")	D8031-DA124	235.62.301

Supplied With

- 2 keys
- Straight cam
- Offset cam
- Spacer
- Spur washer
- Cylinder nut
- 2 screws

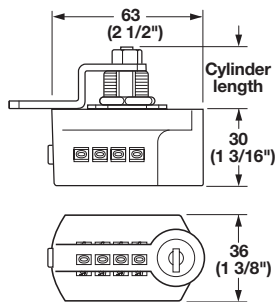

Recommended hole locations

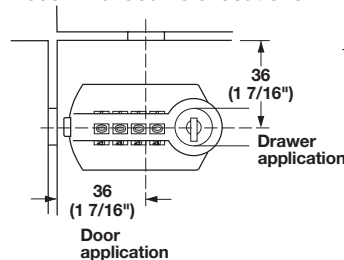

Recommended mounting hole dimensions

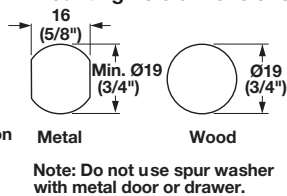

Flush drawer application

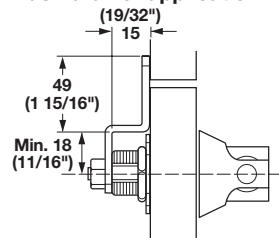

Flush door application

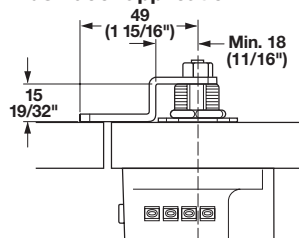

Dimensional data not binding. We reserve the right to alter specifications without notice.