

High Security – National Lock

- Locks on this page meet or exceed ANSI/BHMA Grade 1 cylinder pull and cycle test
- Approved by the Woodworkers Institute (formerly WIC)
- Custom Master keying and General Master key systems available upon request
- 2500 key changes are possible
- Please include a key plan
- Plan on 2–3 weeks to produce

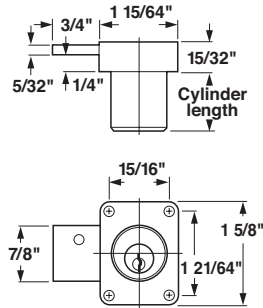

Door Locks

- For right or left hand applications
- 4 pin tumblers = 850 key changes
- Cylinder length 7/8", Bolt travel 3/4"
- Surface mounted, requires a Ø57/64" hole
- Key turns 360°

Keyed Different

Material: Lock and keys: Brass-plated; Strike: Brass-plated

Finish	National No.	Item No.
brushed chrome	C8173-KD-26D	232.14.400
satin brass	C8173-KD-4	232.14.500

Master Keyed, Keyed Different

- Random key numbers only – no specific key numbers can be specified
- Please order master key separately (see below)

Material: Lock and keys: Brass-plated; Strike: Brass-plated

Finish	National No.	Item No.
brushed chrome	C8173-MKKD-26D	232.14.497

Keyed Alike

Finish	Keying #'s	National No.	Item No.
brushed chrome	101	C8173-101-26D	232.14.401
brushed chrome	103	C8173-103-26D	232.14.402
brushed chrome	107	C8173-107-26D	232.14.403
brushed chrome	915	C8173-915-26D	232.14.404
satin brass	107	C8173-101-4	232.14.503
satin brass	915	C8173-915-4	232.14.504

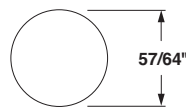
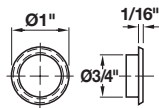

Mounting Hole

Cylinder Rosettes

Material: Brass

Finish	National No.	Item No.
brushed chrome	C2017-26D	232.14.000
satin brass	C2017-4	232.14.001



Master Key

- For MKKD locks above

Material: Brass

National No.	Item No.
D4299	210.02.209

Note

The PLUS feature allows you to remove the cylinder from our pin tumbler box locks while the lock remains in place. No mounting screws need to be removed. Simply use a 5/64" hex wrench from the back to remove the cylinder for re-keying.

